

DESCRIPTION	REVISIONS	DATE

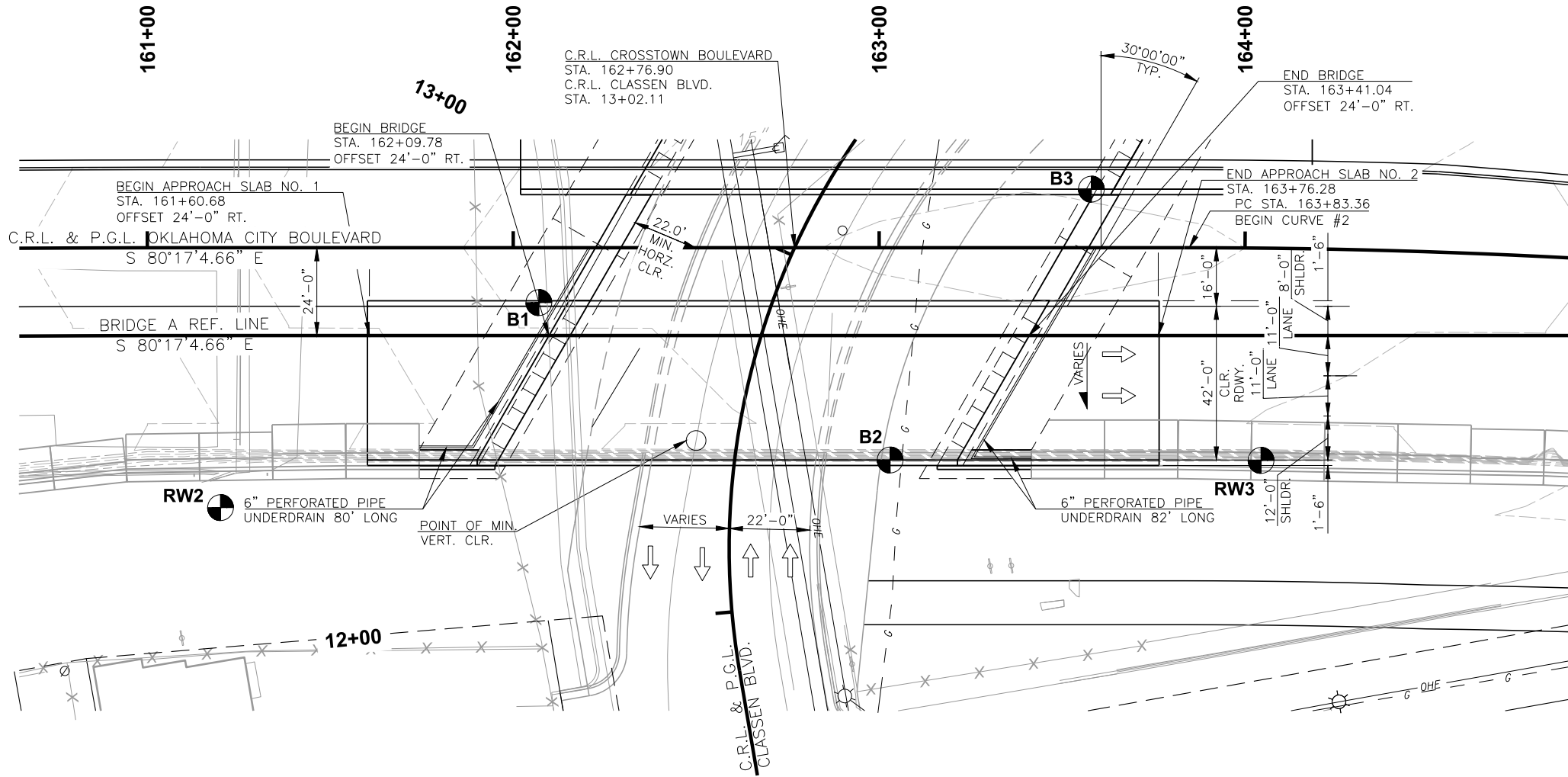

**DESIGN DATA**

CONCRETE CLASS A f'c = 3 K.S.I.  
 CONCRETE CLASS AA f'c = 4 K.S.I.  
 REINFORCING STEEL (GRADE 60) fy = 60 K.S.I.  
 STRUCTURAL STEEL M 270 (GRADE 50W) fy = 50 K.S.I.  
 STAINLESS STEEL A240 (TYPE 316) fy = 30 K.S.I.

LOADING:  
 HL-93 OR OKLAHOMA OVERLOAD TRUCK  
 20 P.S.F. FUTURE WEARING SURFACE  
 5 P.S.F. STAY-IN-PLACE FORMS

DESIGN:  
 AASHTO LRFD BRIDGE DESIGN SPECIFICATIONS, 7TH EDITION.  
 ANSI/AASHTO/AWS D1.5 BRIDGE WELDING CODE  
 ANSI/AASHTO/AWS D1.6 STRUCTURAL WELDING CODE - STAINLESS STEEL.

LFD OPERATING RATING: HS 46.8

NOTE:  
 FOR SHEET INDEX, LIST OF STANDARDS, SUPERELEVATION DATA, SUMMARY OF PAY QUANTITIES, AND FOUNDATION DATA, SEE SHEET 74.

OKLAHOMA CITY BOULEVARD  
 CURVE #2  
 P.I. STA. = 167+28.23  
 $\Delta = 19d34'02.98''$   
 R = 2000.00'  
 T = 344.88'  
 L = 683.03'  
 D = 2d51'53.24"  
 E = 29.52'

CLASSEN CURVE GEOMETRY  
 P.I. STA. = 03+28.41  
 $\Delta = 63d12'56''$   
 R = 198.0000'  
 T = 121.8477'  
 L = 218.4576'  
 C = 207.5445'  
 D = 28d56'14''

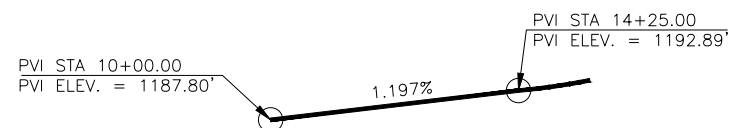

**P.G.L. CLASSEN BLVD.**

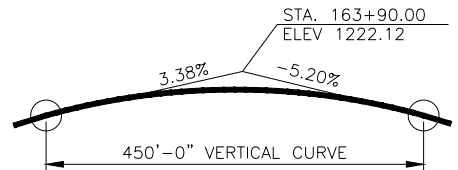

**VERTICAL CURVE DATA  
 P.G.L. OKLAHOMA CITY BLVD.**

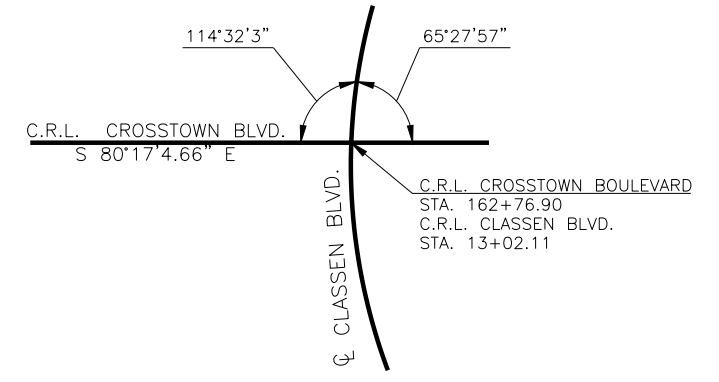

**OKLAHOMA CITY BLVD. AND  
 CLASSEN BLVD.  
 ALIGNMENT GEOMETRY**

BM #209 CUT "X" T/C PC SE-S SHERIDAN & WESTERN  
 STA 162+01.49 387.79' LT. OF CL SURVEY  
 ELEV=1196.82'

**PLAN**  
 1" = 20'

BM #54 CUT "X" T/C PCR SW-W CALIFORNIA & CLASSEN  
 STA 165+46.43 103.57' LT. OF CL SURVEY  
 ELEV=1196.30'

NOTE:  
 BRIDGE A PIPE UNDERDRAIN COUPLES WITH RETAINING WALL AND BRIDGE B PIPE UNDERDRAINS. SLOPE UNDERDRAIN TO DRAIN TO THE NORTH. SEE BRIDGE B GP&E FOR ADDITIONAL DETAIL.

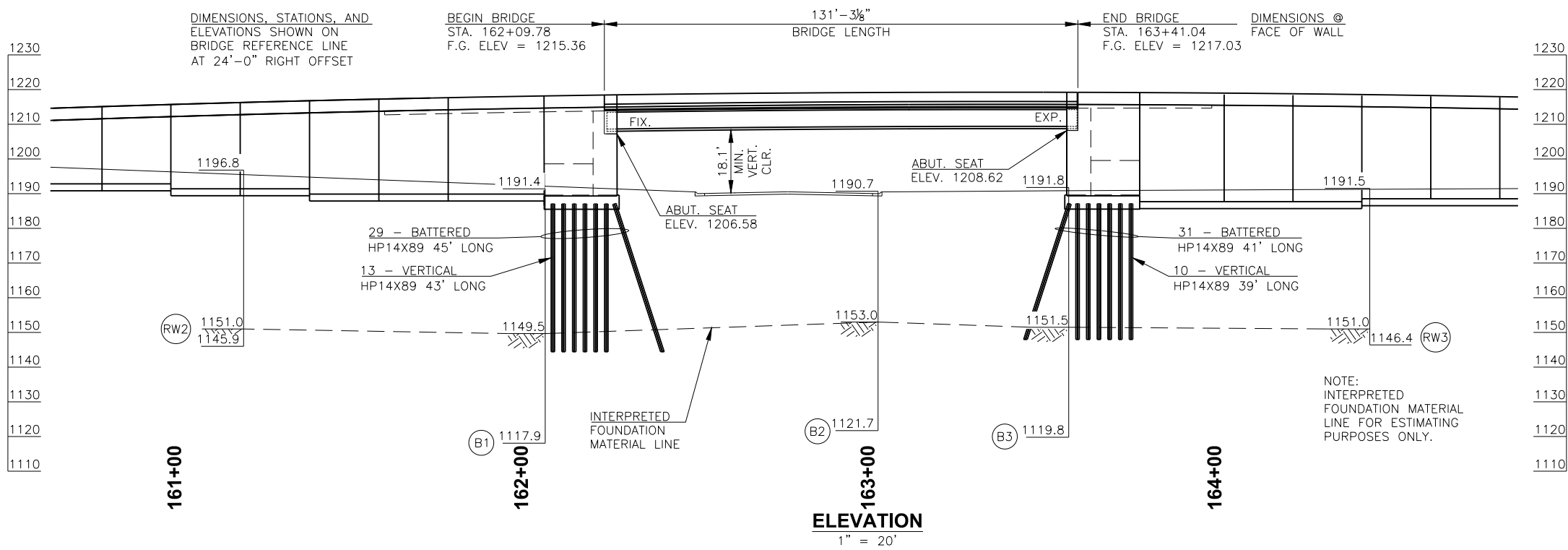

**ELEVATION**  
 1" = 20'

NOTE:  
 INTERPRETED FOUNDATION MATERIAL LINE FOR ESTIMATING PURPOSES ONLY.

DESIGN	T.A.C.	OKLAHOMA CITY BLVD.	OKLAHOMA COUNTY
DRAWN	R.A.P.	OVER CLASSEN BLVD.	BRIDGE A
<b>GENERAL PLAN AND ELEVATION</b>			
CHECKED	T.A.C.	131' TYPE J P.C.B. SPAN, SKEW 30',	
APPROV.	T.A.C.	42' CLR. RDWY., F-SHAPED PARAPETS @ STA. 162+75.41	
SQUAD	CEC	JOB PIECE NO. 17428(88) SHEET NO. 73	